



# Primer

## LCA-16/22 T2 BARRIER WASHER EXTRACTORS



### CONTROL T2

User friendly and programmable Control T2 with a 7" touch screen

Display on dirty side

USB Connection. PC software free of charge for programming, telemetry, data analysis...

37 available languages

8 dosing signals as standard



### OUTSTANDING FEATURES

Automatic positioning of drum

2 water inlets

Wet cleaning, telemetry standard

G-FACTOR 350

Heating: electric, steam, and dual heating model (electric+steam)



### EFFICIENCY

Intelligent consumption

Optimal loading

Water Recovery tanks ready: SAVETANK

Low water consumption

High G-FACTOR: reduced residual moisture > reduced drying time



### CONNECTIVITY

IoT - PRIMERLINK standard

Remote technical service

Laundry management



### ERGONOMICS

Huge door opening making loading/unloading easier

Easy friendly drum opening by push button

Loading height: door base 670 mm



### MAINTENANCE

Electric components on the left side, mechanical components on the right side and connections on the top (protected from water and detergents)

Central drain as standard

Technical menu: statistics, alarms, autotest, data recovery for technicians and maintenance



### OTHERS

2 opposed doors. Pass-through barrier washer.

Ready to be connected to dosing pumps

Grey skinplate outer casing

Drum and vat in stainless steel AISI 304

Frequency inverter to control imbalance

CE approved product



### OPTIONS

- 1-door opening (single side operation)
- 7" second screen on clean side
- Automatic weighing sensor system on feet (Includes kit with 6 extra dosing signals)
- Relay card with 6 extra dosing signals: up to 14 signals
- Printer
- Third water inlet
- Double drain
- Titration valve
- Side drain valve
- Low steam pressure (0,5 bar)
- Detergent box with 4 compartments
- Electric drum motor brake
- UPS Option (in case of power failure)
- End of cycle light alarm
- Plinth to align loading height (door base at 850mm)
- Stainless steel AISI 304 outer casing
- Stainless steel AISI 304 sanitary frame
- Other voltages

TECHNICAL DATA	UNIT.	LCA-16 T2	LCA-22 T2		
<b>DRUM</b>					
Capacity 1:9 / 1:10	Kg	18 / 16	24 / 22		
Volume	l	158	220		
Diameter	mm	633	633		
Depth	mm	500	700		
No of drum compartment	No	1	1		
Pullman partition of drum		N/A	N/A		
<b>GENERAL DETAILS</b>					
Washing / spin speed	r.p.m.	45 / 1000	45 / 1000		
G Factor	-	350	350		
Dynamic force	KN	5,5 ±1,12	6,25 ±1,54		
Dynamic force frequency	Hz	15,4	15,4		
Sound level	dB	<70	<70		
Double drain	-	OPT	OPT		
Weighing system	-	OPT	OPT		
<b>DRUM</b>					
Height door bottom	mm	670	670		
Drum opening dimensions	mm	400 x 315	400 x 315		
Vat opening dimensions	mm	455 x 415	455 x 415		
<b>POWER</b>					
Motor	kW	2,2	2,2		
Electric heating	kW	12	18		
Total electric power (elec mod)	kW	14,2	20,2		
Total electric power (steam mod)	kW	2,2	2,2		
<b>CONNECTIONS</b>		<b>ELECTRIC / DUAL</b>	<b>STEAM</b>	<b>ELECTRIC / DUAL</b>	<b>STEAM</b>
Tension 230V - I + N + T	Nº x mm2 / A	-	3 x 1,5 / 6A	-	3 x 1,5 / 6A
Tension 230V - III + T	Nº x mm2 / A	4 x 10 / 40A	-	4 x 10 / 50A	-
Tension 400V - III + N + T	Nº x mm2 / A	5 x 6 / 25A	-	5 x 6 / 32A	-
steam inlet (steam mod)	Inch	3/4"		3/4"	
Max. steam consumption	Kg/h	9		12	
Water inlet	Inch	3/4"		3/4"	
Water pressure	Kgs/cm <sup>2</sup>	3-5		3-5	
Max. water consumption*	Lit/h	144		198	
Drain	Inch	3"		3"	
Drain flow	Lit/min	160		160	
<b>OVERALL DIMENSIONS / PACKING DIMENSIONS</b>					
Net width / Gross width	mm	1.056 / 1.072		1.245 / 1.262	
Net depth / Gross depth	mm	1.071 / 1.102		1.071 / 1.102	
Net height / Gross height	mm	1.417 / 1.530		1.417 / 1.530	
Net weight / Gross weight	kg	438 / 459		471 / 494	
Volume	m <sup>3</sup>	1,60 / 1,81		1,88 / 2,13	

\* N°2 Program, 100% load

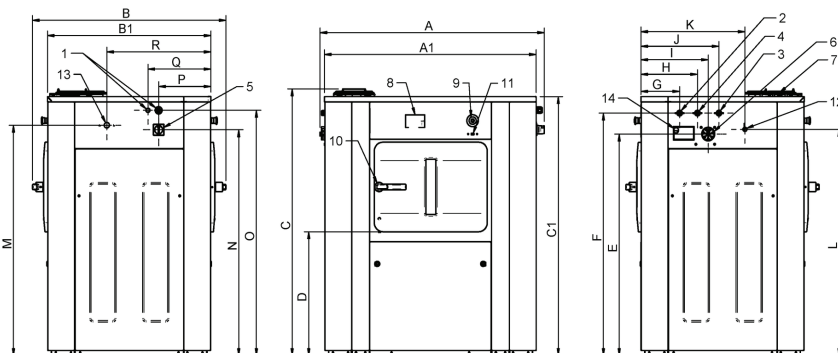

01. Electrical connexion
02. Hot water
03. Cold water
04. Soft water
05. Main switch
06. Liquid products inlet
07. Detergent box (option)
08. Control panel
09. Emergency stop
10. Door opening
11. USB port
12. Dosing pumps connexion
13. Steam inlet
14. Exhaust

	A	B	C	A1	B1	C1	D	E	F	G	H	I	J	K	L	M	N	O	P	Q	R
LCA-16	1.054	1.082	1.426	984	914	1.385	661	1.184	1.296	217	317	377	437	582	1.209	1.231	1.207	1.311	292	352	582
LCA-22	1.254	1.082	1.426	1.184	914	1.385	661	1.184	1.296	217	317	377	437	582	1.209	1.231	1.207	1.311	292	352	582

